

BUILDING KEY PLAN

N.T.S.

North

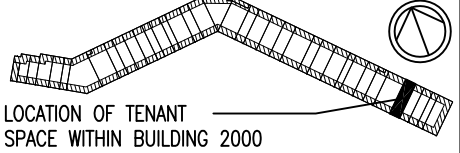

EXISTING ELECTRICAL & TELECOM SERVICE

EXISTING BATHROOMS

ADJACENT TENANT (N.I.C.)

ADJACENT TENANT (N.I.C.)

(C)

EXISTING DEMISING WALLS, 6" METAL STUDS (20GA) @ 24" O/C FROM FINISHED FLOOR TO BOTTOM OF ROOF DECK W/ 5/8" TYPE 'X' GYP BD SHEATHING AND SOUND BATT INSULATION

(B)

SPACE 2531
3,500 S.F. TOTAL
 2531 Shoppes Boulevard

EXISTING 8"x8" TUBE STEEL BUILDING COLUMNS

(A.1)

(A)

TYPICAL EXISTING DEMISING PIER BY LANDLORD

(35.5)

(36)

(36.5)

EXISTING REAR DOOR

LEASE LINE

LEASE LINE

LEASE LINE

LEASE LINE

40'-0"

40'-0"

120'-0 1/2"

29'-2" C/L WALL TO C/L WALL

4'-11"

20'-0"

4'-3"

38'-8"

1'-4 1/2"



LEASE OUTLINE DRAWING (LOD)

BUILDING 2000, TENANT SPACE 2531

SCALE: 1/16" = 1'-0"
1/28/2016

THE SHOPPES AT MONTAGE
MOOSIC, PA
LACKAWANNA COUNTY

US Properties Group, Inc
3665 Fishinger Blvd
Hilliard, OH 43026

